



service bulletin

No. 98-1

Siphon Break – Sport Jet

NOTICE

Revised September 1998. Destroy original May 1998 Bulletin. Changes are underlined.

Models Affected

Sport Jet 175XR² – Serial number **0E288000** thru **0E341671**

It has recently come to our attention that the hole in the siphon break may be “flashed over” (not open). This condition may allow water to siphon back into the boat after the engine is turned off. Water siphoning back into the boat can only occur when water is being drawn out through the siphon system at the time the engine is turned off.

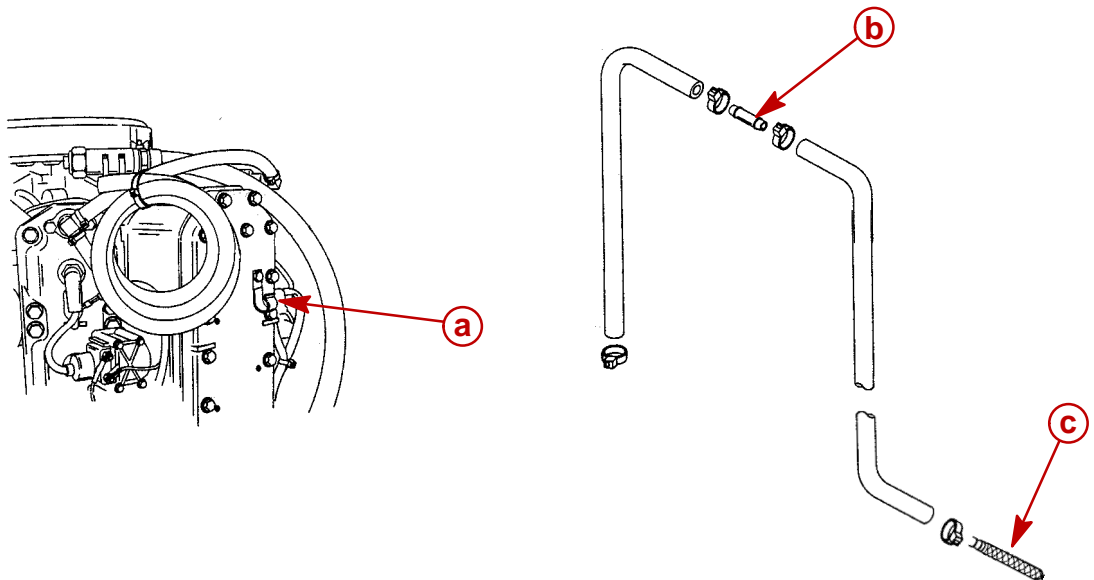

- a** - Clamp for Siphon Break
- b** - Siphon Break
- c** - Screen End which Lays in Bilge

Dealer Boat Inventory

Boats with the Sport Jet 175XR² that are within the serial number range and do not have the repair identification must have a new siphon break installed prior to customer delivery.

Correction

Siphon break and hose assembly are secured to the exhaust manifold with an open end clamp. Remove assembly from the clamp. Cut the cable ties securing both hoses to the siphon break. Replace siphon break with new part and secure siphon break to hoses using new cable ties. Reinstall siphon break assembly to clamp on exhaust manifold.

Parts Required

Order : Qty. 1 of 826702 Siphon Break
 Qty. 2 of 816311 Cable Tie

Repair Identification

- All powerheads with the correct siphon break will be identified by a colored dot on the top of the sound attenuator.
- All powerheads with the serial number **0E341672 and higher** have the proper siphon breaks.

Warranty

Complete a warranty claim listing:

- Powerhead serial number(s)
- Siphon Break(s)
- One half (.5) hour labor
- Warranty Labor rate code – NJC
- Failure code – 619

US & CANADA

Hold parts for 60 days after receipt of warranty credit invoice. Properly tag all parts by claim (serial) number.

INTERNATIONAL

Hold parts for disposition by a Marine Power technical representative.